

STÖRK

sampling solutions



STÖRK RAIL



STÖRK COMPACT



STÖRK PRO





STORK
sampling solutions

DV GROUP

1987

DV -

1982 . 1987 .



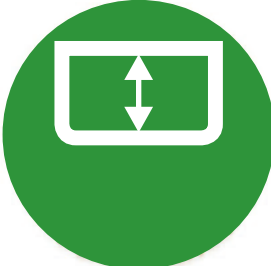

1

2

3

2,2 KW

4

5

6

7

8

10

STORK

10

STORK





1998

ISO 9001

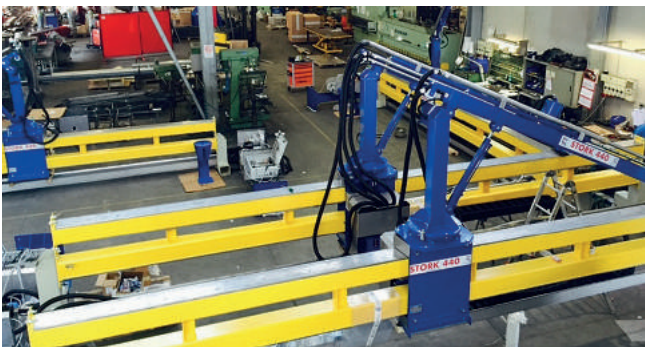

STORK 440



STORK COMPACT

STORK COMPACT

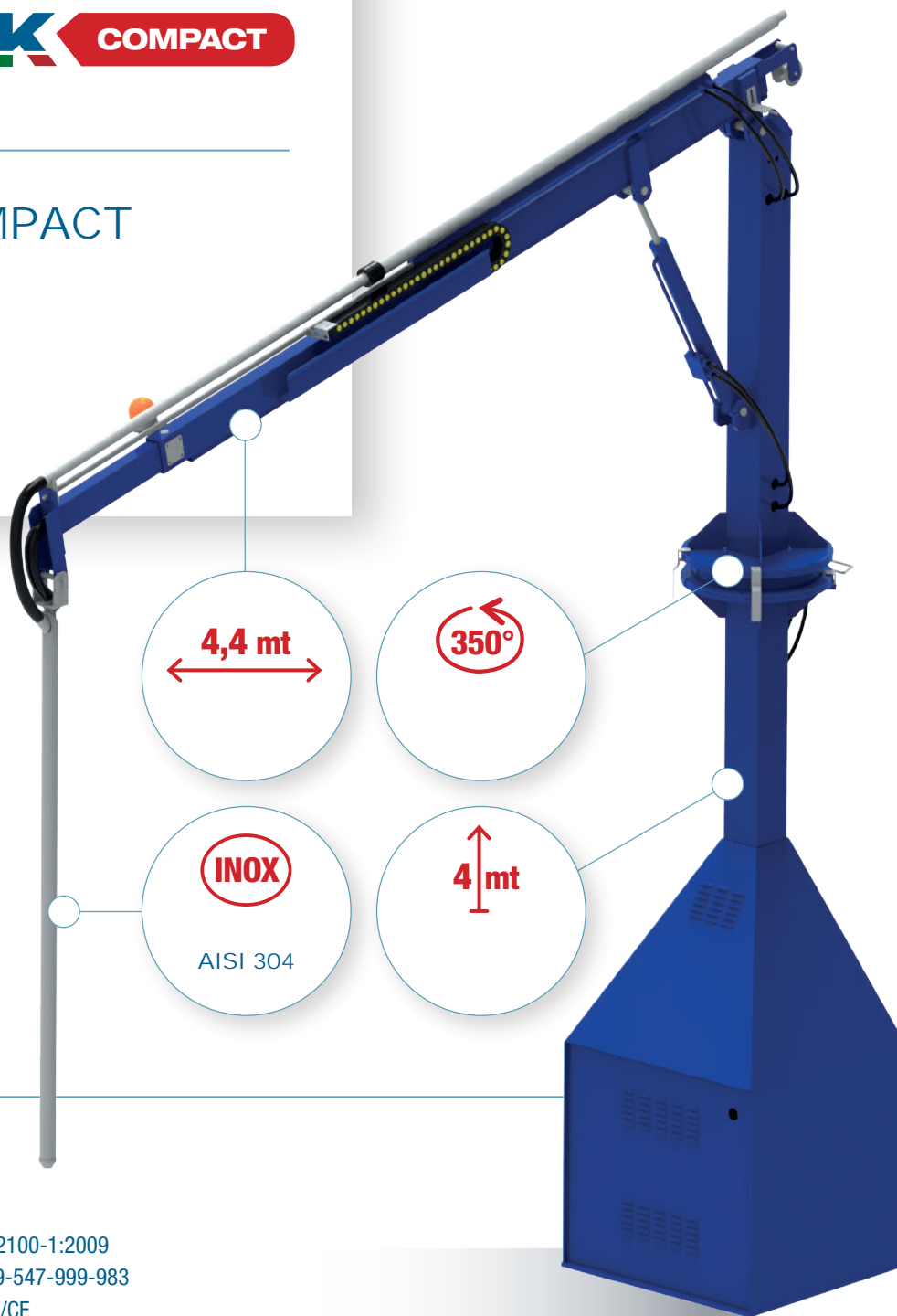

4,4 mt

350°

INOX

AISI 304

4 mt

400 VAC 3P + N + E 50 HZ

2,2 KW

1,5 KW

830 KG

350°

UNI EN ISO 24333-2010 / UNI EN ISO 12100-1:2009
UNI EN ISO 13857 - 13850 / UNI EN 349-547-999-983
2006/42/CE / 2006/95/CEE / 20447108/CE



COMPACT

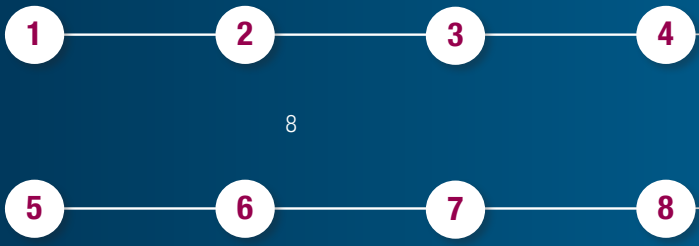

350°



/

2,2 KW

+

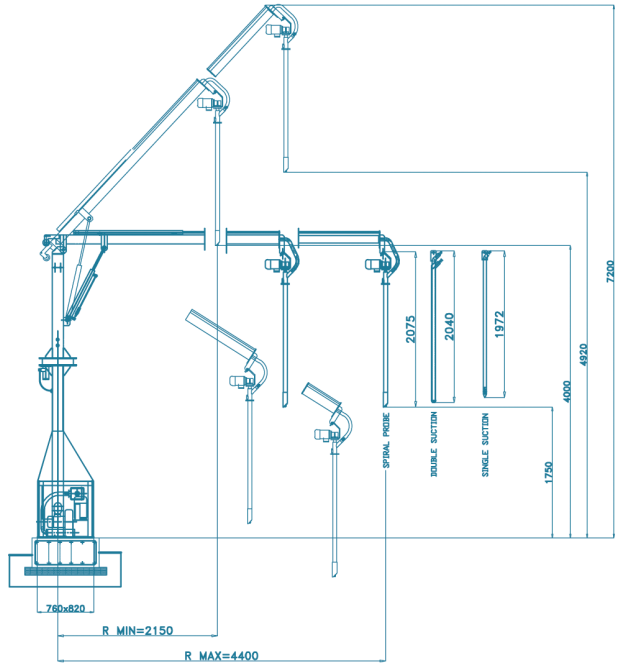
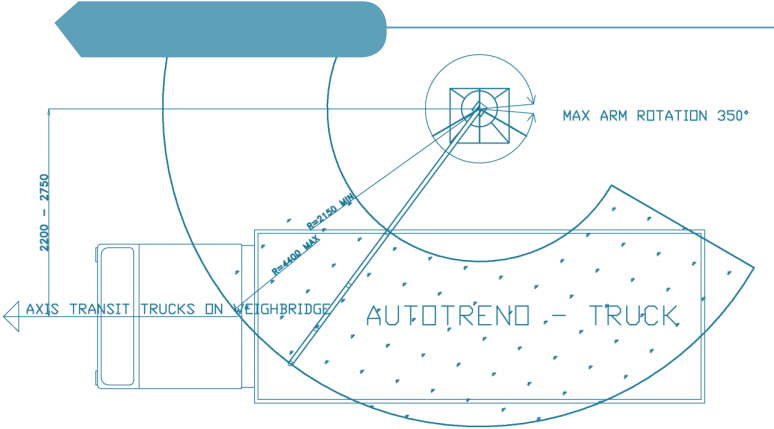

1

2000 MM

2500 MM
2700 MM
3000 MM



2

2000 MM

2300 MM
2500 MM
2700 MM



3

2000 MM

2300 MM
2500 MM



STORK RAIL



400 VAC 3P + N + E 50 HZ

2,2 KW

1,5 KW

1750 KG

350°

INOX

AISI 304

5,1 mt

UNI EN ISO 24333-2010 / UNI EN ISO 12100-1:2009
UNI EN ISO 13857 - 13850 / UNI EN 349-547-999-983
2006/42/CE / 2006/95/CEE / 20447108/CE

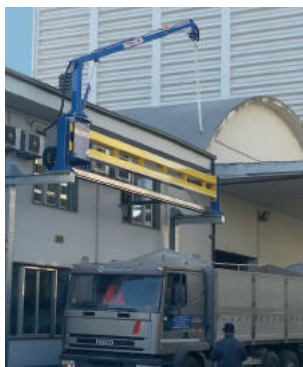

RAIL

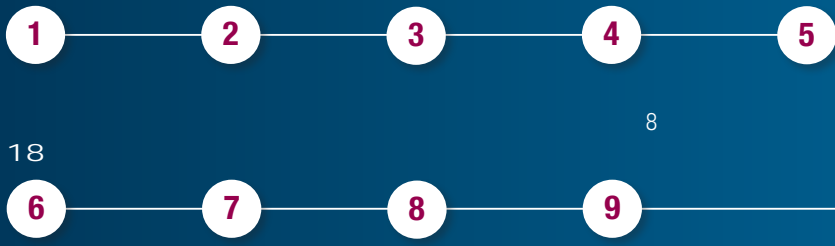

18
350°

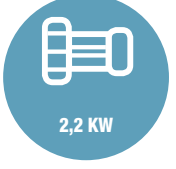
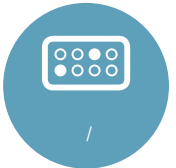

18

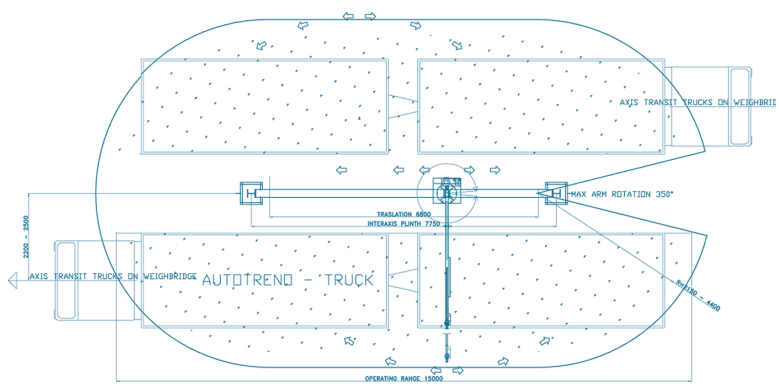
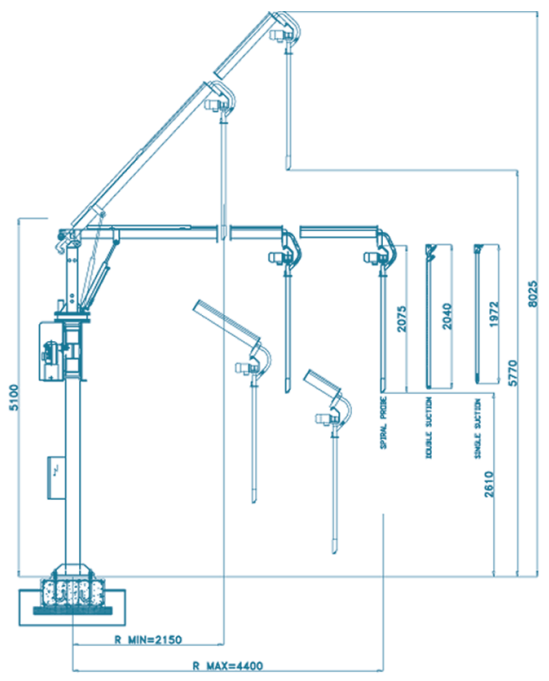

1

2000 MM

2500 MM
2700 MM
3000 MM

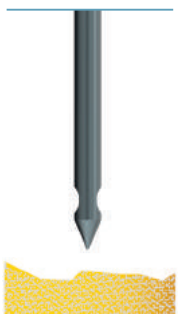

2

2000 MM

2300 MM
2500 MM
2700 MM



3

2000 MM

2300 MM
2500 MM



COMPACT AND RAIL

HYBRID SERIES

STORK HYBRID

5

60

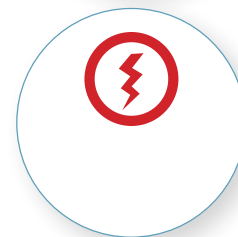

400 VAC 3P + N + E 50 HZ

2,2 KW



1,5 KW

350°

UNI EN ISO 24333-2010 / UNI EN ISO 12100-1:2009
UNI EN ISO 13857 - 13850 / UNI EN 349-547-999-983
2006/42/CE / 2006/95/CEE / 20447108/CE

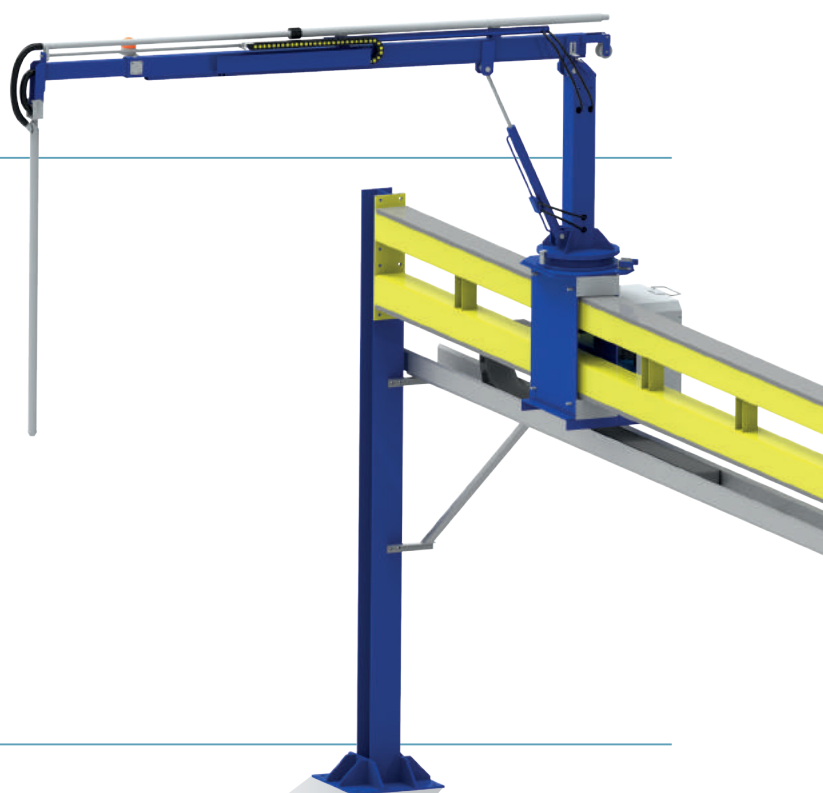
COMPACT HYBRID 830 KG
RAIL HYBRID 1750 KG

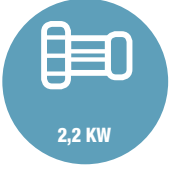

 /
 2,2 KW

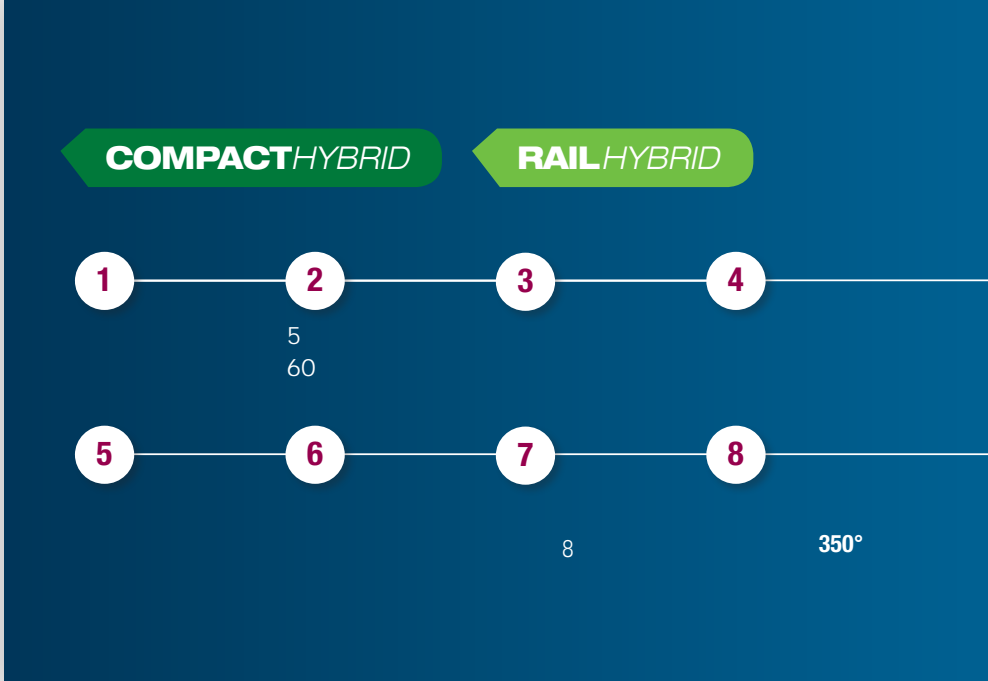
 +



HYBRID / /

STORK HYBRID

60 , . 5



1

2000 MM

2500 MM
2700 MM
3000 MM

2

2000 MM

2300 MM
2500 MM
2700 MM

3

2000 MM

2300 MM
2500 MM

STORK PRO

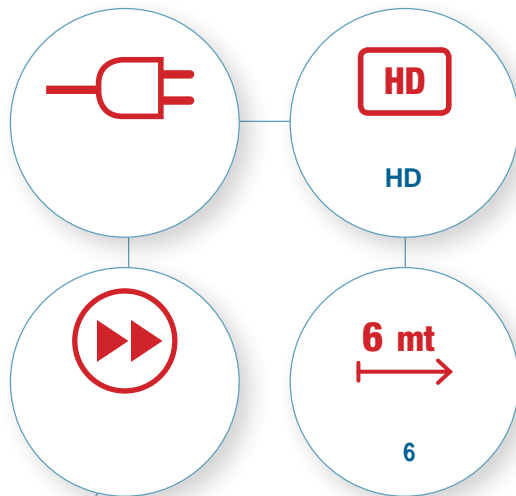

UNI EN ISO 24333-2010 / UNI EN ISO 12100-1:2009
UNI EN ISO 13857 - 13850 / UNI EN 349-547-999-983
2006/42/CE / 2006/95/CEE / 20447108/CE



400 VAC 3P + N + E 50 HZ

2,2 KW

PRO

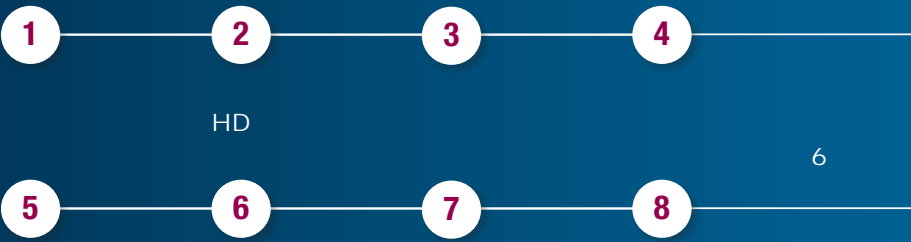
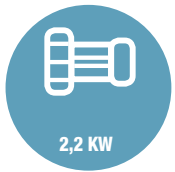

HD

6

WINDOWS 8

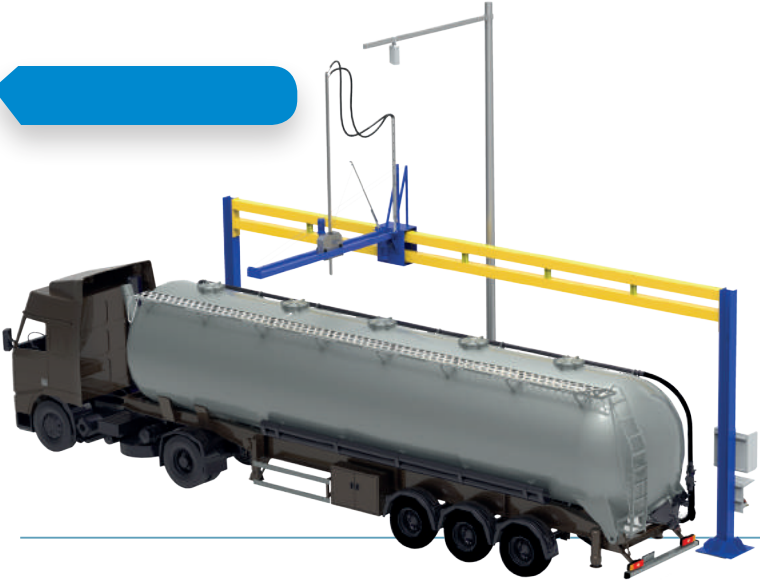
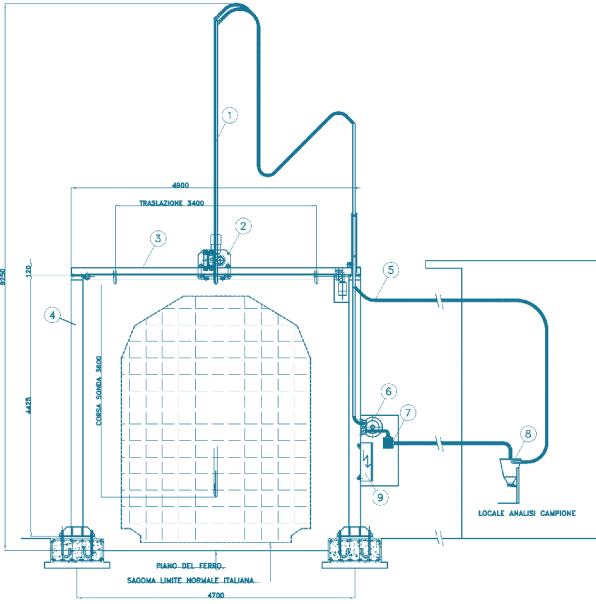

COMPACT AND RAIL

AUTOMATIC SERIES

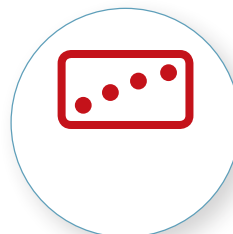

2 7

()
 ()

(ITA-ENG-RUS)

2/3



4

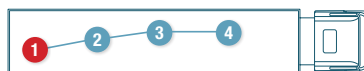

6





STORK PRO

AUTOMATIC SERIES

STORK PRO

HD

WINDOWS 8

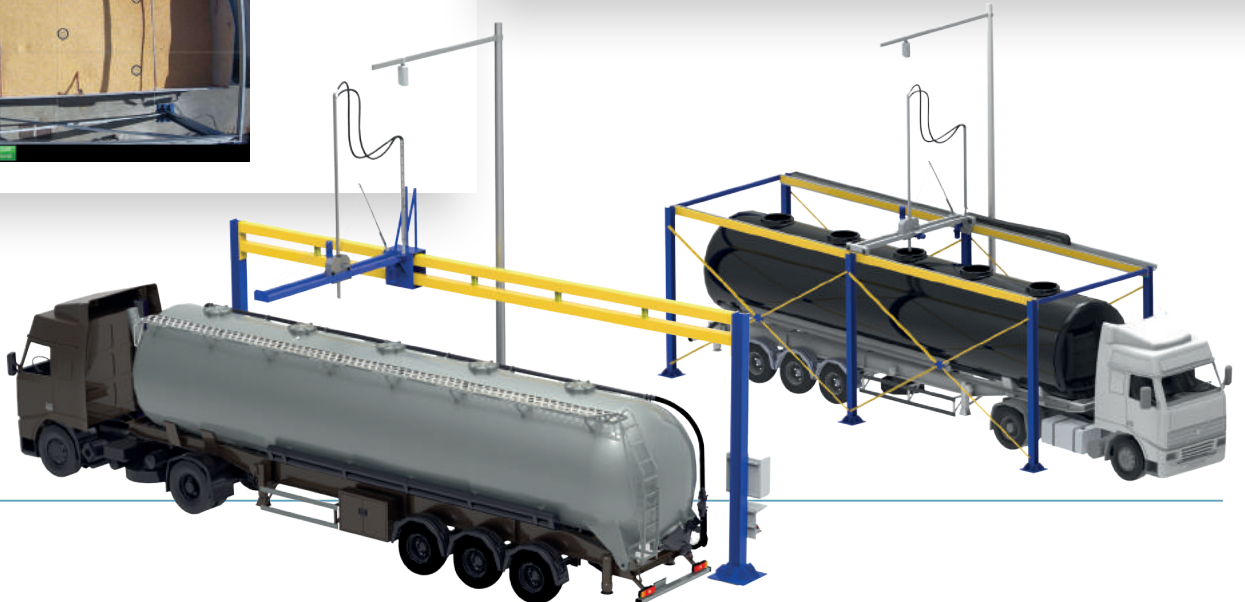



- 1
- 2
- 3
- 4
- 5
- 6

- 1
- 2
- 3
- *

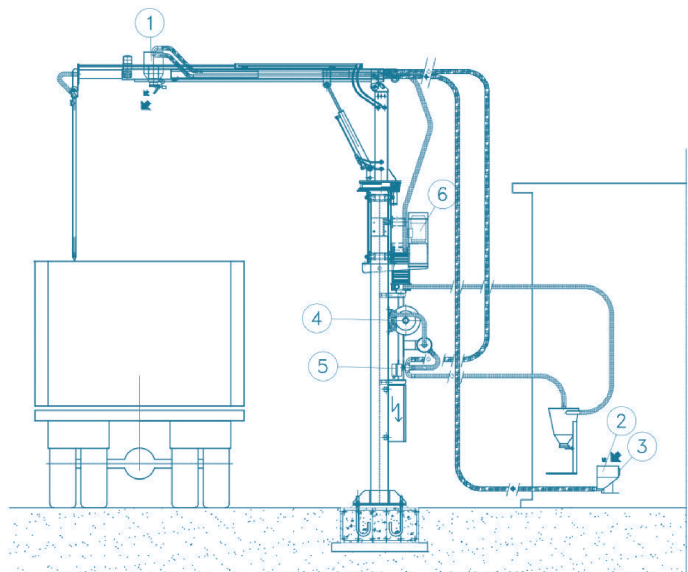

1

2

4

2

1

3

*



1

(1 , 2 ,)

2

*

STORK COMPACT RAIL.



1

23

3,6
800 tvl, 960 H, IP 66
20

2

3

LED 20"



STORK LOCATION

DV

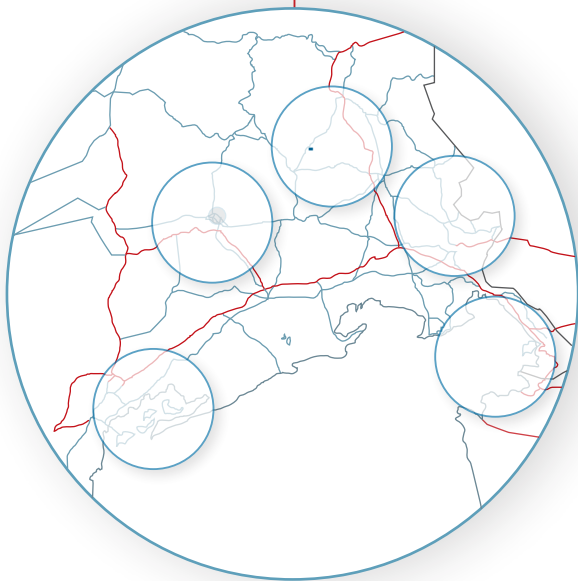

www.lonelyplanet.com

> 90 KM



> 105 KM



> 90 KM





D.V. srl
Depuration Vehiculer

Via E.Ellero n.9 33080 Cusano di Zoppola (Pn) Italy
Tel. 0039_0434 574192 r.a. Fax 0039_0434 977070
info@dvsrl.com www.dvsrl.com



www.grainsamplers.com



STORK
sampling solutions



www.grainsamplers.com



DV *SRL*

Soluzioni Tecnologiche
per l'Industria Agroalimentare

www.dvsrl.com